

# HUTCHINSON TOWNSHIP

Each township has six files containing six sections in each, and one file containing all 36 sections.

Hutchinson01to06.pdf  
Hutchinson07to12.pdf  
Hutchinson13to18.pdf  
Hutchinson19to24.pdf  
Hutchinson25to30.pdf  
Hutchinson31to36.pdf  
HutchinsonAll36.pdf

The points are listed starting with the point above the SE corner and continuing in a counter-clockwise rotation around the section. This normally begins with the East point, Northeast, then North, but may also include Witness Corners, and/or Meander Corners.

## **Definitions**

**Witness Corner:** A witness corner “stands in” when the true corner cannot be monumented or occupied because of difficult terrain or obstruction of the corner sight. The witness corner must be on the section line and is usually 5 or 10 chains away from the true corner.

**Meander Corner:** The intersection of a township, range, or section line and the banks of a navigable stream or meandering body of water.

EAST QUARTER corner, Section 13, Township 117 North, Range 29 West

## Certificate of Location of Government Corner

## SKETCH OF REFERENCE TIES

(NO SCALE)

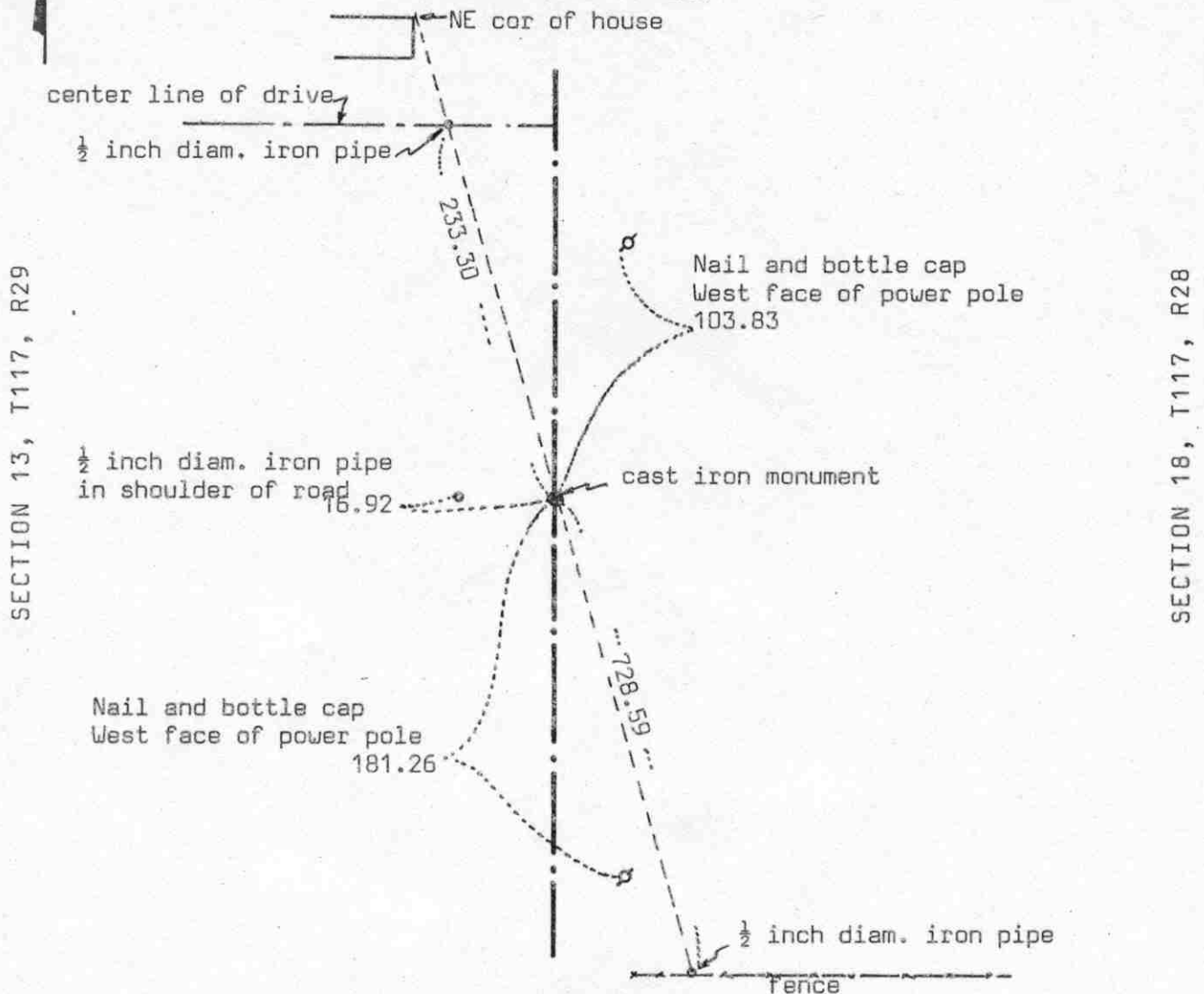

Statement of evidence relative to this corner location on sheet 2

I hereby certify that this document  
was prepared by me or under my  
direct supervision.

Willard Pellinen  
Willard Pellinen  
McLeod County Surveyor  
License No. 9626

Date 6/17/90

OFFICE OF THE COUNTY RECORDER  
MCLEOD COUNTY, MINNESOTA.

I hereby certify that this document was filed in this  
office at 2 o'clock P.M. on the 21st day  
of June, 1990.

Carmen Ostlie, County Recorder  
By Joan Petrick, Deputy  
Document No. 234012

EAST QUARTER corner, Section 13, Township 117 North, Range 29 West

## *Certificate of Location of Government Corner*

August, 1855. John Ryan of the General Land Office established this corner. He set a post and had ties to 2 aspens.

October 2, 1970. McCombs Knutson Associates (Dickman Knutson, county surveyor) dug for the corner. (John Tupa from Hutchinson, with a backhoe) They found a stone and a wood stake down 3 feet below the road surface.

October 13, 1970. Knutson set a McLeod County cast iron monument and took additional reference ties.

April 10, 1981. We found the monument in good condition and took new reference ties.

July 5, 1981. We took some long distance ties. Road to be rebuilt and the close ties will be destroyed.

June 18, 1986. We reset a cast iron monument, using the 1981 reference ties and took additional ties.

April 7, 1989. We found the monument in good condition and the reference ties good.

We accept the stone and wood stake found by Knutson as having perpetuated the correct location of the quarter corner.

NORTHEAST corner, Section 13, Township 117 North, Range 29 West

## Certificate of Location of Government Corner

SKETCH OF REFERENCE TIES  
(NO SCALE)

SECTION 12, T117, R29

SECTION 7, T117, R28

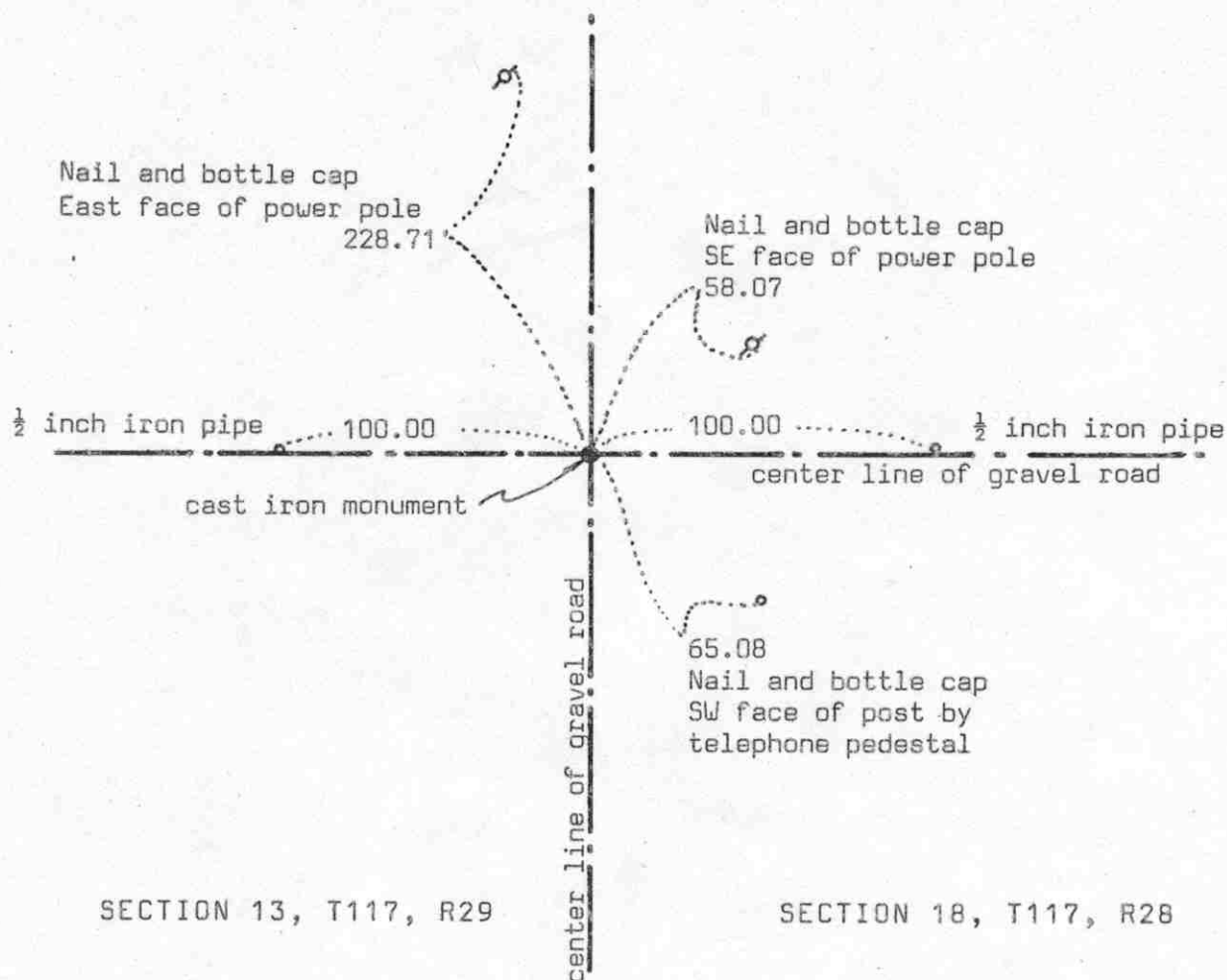

Statement of evidence relative to this corner location on sheet 2

I hereby certify that this document  
was prepared by me or under my  
direct supervision.

Willard Pellinen

Willard Pellinen  
McLeod County Surveyor  
License No. 9626

Date 6/17/90

OFFICE OF THE COUNTY RECORDER  
MCLEOD COUNTY, MINNESOTA.

I hereby certify that this document was filed in this  
office at 2 o'clock P.M. on the 21st day  
of June, 1990.

Carmen Optlie, County Recorder

By Jan Petrick, Deputy

Document No. 234011

## *Certificate of Location of Government Corner*

August, 1855. This corner was established by the General Land Office. John Ryan set a post and had reference ties to 4 bearing trees.

April 17, 1970. McCombs Knutson Associates (Dickman Knutson, county surveyor) dug for the corner, John Tupa from Hutchinson, with a backhoe. They found a wood stake and a 1 inch by 1 inch by 18 inch iron below the wood stake and a stone beside the iron. They took reference ties to the stone and set a McLeod County cast iron monument over the stone.

March, 1974. Monument was in good condition but the reference ties were destroyed. Knutson took new ties.

April 10, 1981. We set a half inch diameter iron pipe 100.00 feet east and a half inch iron pipe 100.00 feet west of the monument in a straight line. Road to be rebuilt.

June 18, 1987. We found the monument in good condition down 10 inches below the road surface. We took new reference ties.

April 7, 1989. The monument and reference ties were ok.

We accept the stone found by Knutson as having perpetuated the correct location of the section corner.

NORTH QUARTER corner, Section 13, Township 117 North, Range 29 West

# Certificate of Location of Government Corner

## SKETCH OF REFERENCE TIES

(NO SCALE)

SECTION 12

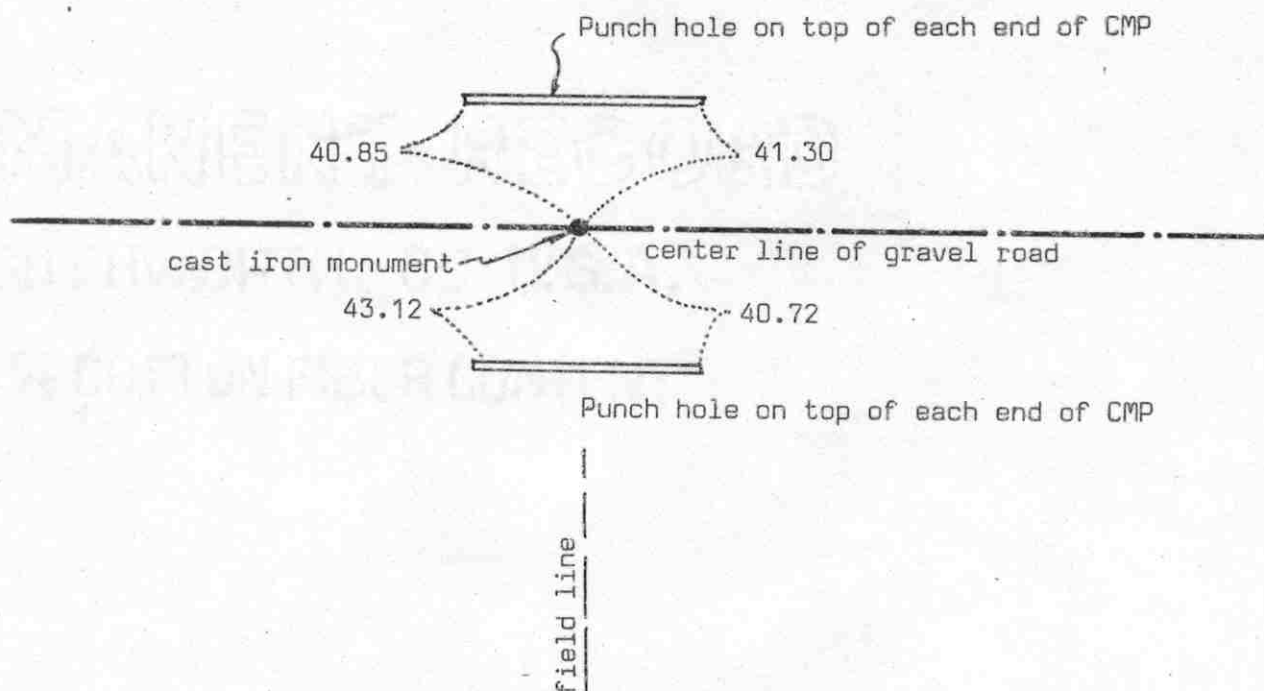

SECTION 13

Statement of evidence relative to this corner location on sheet 2

I hereby certify that this document was prepared by me or under my direct supervision.

Willard Pellinen

Willard Pellinen  
McLeod County Surveyor  
License No. 9626

Date June 17, 1990

## OFFICE OF THE COUNTY RECORDER MCLEOD COUNTY, MINNESOTA.

I hereby certify that this document was filed in this office at 2 o'clock P.M. on the 21st day of June, 19 90.

Carmen Ostlie, County Recorder  
By Jan Petrick, Deputy  
Document No. 234013

NORTH QUARTER corner, Section 13, Township 117 North, Range 29 West

## Certificate of Location of Government Corner

May, 1856. A.H Runyon of the General Land Office established this corner. He set a post and had reference ties to a 7 inch hickory and an 18 inch aspen.

March 12, 1974. McCombs Knutson Associates (Dickman Knutson, county surveyor) measured the north line of Section 13 and set a temporary north quarter corner on the center line of the road in line with a field line running south. Mr. Edward Klima, 64 years old, has lived in the Northeast Quarter of Section 13 for 12 years, agreed this is where the corner should be.

May 15, 1974. Knutson dug for the corner (John Tupa from Hutchinson with a backhoe). Down 3 feet below the road surface they found a 6 inch diameter stone, 12 inches long, set on end. This was very close to the temporary corner. This point is within 5 feet of being on a split between the section corners.

November 14, 1974. Knutson set a McLeod County cast iron monument and took reference ties.

April 7, 1989. We found the monument in good condition and the reference ties good.

We accept the stone found by Knutson as having perpetuated the correct location of the quarter corner.



EAST QUARTER corner, Section 14, Township 117 North, Range 29 West

# Certificate of Location of Government Corner

## SKETCH OF REFERENCE TIES (NO SCALE)

SECTION 14

SECTION 13

Nail and disc  
East face of power pole  
179.74

Nail and disc  
NW face of power pole  
37.10

cast iron monument

Nail and disc  
East face of power pole  
126.15

249.77  
Nail and disc  
West face of power pole

center line of bituminous road

fence

Statement of evidence relative to this corner location on sheet 2

I hereby certify that this document was prepared by me or under my direct supervision.

Willard Pellinen  
Willard Pellinen  
McLeod County Surveyor  
License No. 9626

Date June 17, 1990

OFFICE OF THE COUNTY RECORDER  
MCLEOD COUNTY, MINNESOTA.

I hereby certify that this document was filed in this office at 9 o'clock A.M. on the 9th day of July, 19 90.

Carmen Ostlie, County Recorder

By \_\_\_\_\_, Deputy

Document No. 234306



EAST QUARTER corner, Section 14, Township 117 North, Range 29 West

## Certificate of Location of Government Corner

May, 1856. This corner was established by the General Land Office. A.H. Runyon set a post and had reference ties to 2 bearing trees.

March 12, 1974. McCombs Knutson Associates (Dickman Knutson, county surveyor) measured the east line of Section 14 and set a temporary quarter corner on the center line of the road in line with a fence to the east. This fence has been accepted as the quarter line by adjoining land owners. This point falls within about a foot of being on a split between the section corners.

June 19, 1974. Knutson set a cast iron monument on the center line of the road in line with the fence and took reference ties.

April 7, 1989. We found the monument in good condition and the reference ties good.

We feel this was an obliterated corner whose location had been perpetuated by the center line of the road and the old fence.

NORTHEAST corner, Section 14, Township 117 North, Range 29 West

## Certificate of Location of Government Corner

SKETCH OF REFERENCE TIES  
(NO SCALE)

SECTION 11

SECTION 12

Nail and bottle cap  
East face of power pole  
71.8035.39 Punch hole on top of west  
end of CMP

96.10

cast iron monument

center line of Co. Hwy No. 5

35.70

Nail and disc  
East face of telephone polechiseled mark on top of  
each end of conc. culv.

71.69

center line of  
Co. Hwy No. 4

SECTION 14

SECTION 13

Statement of evidence relative to this corner location on sheet 2

I hereby certify that this document  
was prepared by me or under my  
direct supervision.Willard PellinenWillard Pellinen  
McLeod County Surveyor  
License No. 9626Date June 17, 1990OFFICE OF THE COUNTY RECORDER  
MCLEOD COUNTY, MINNESOTA.I hereby certify that this document was filed in this  
office at 9 o'clock A.M. on the 9th day  
of July, 1990.Carmen Ostlie, County Recorder

By \_\_\_\_\_, Deputy

Document No. 234305

NORTHEAST corner, Section 14, Township 117 North, Range 29 West

## Certificate of Location of Government Corner

May, 1856. A.H.Runyon of the General Land Office established this corner. He set a post and had reference ties to 4 bearing trees.

March 12, 1974. McCombs Knutson set a temporary corner on the center line County Highway No. 5, in line with a fence to the north and the northerly extension of County Highway No. 4 from the south.

May 15, 1974. McCombs Knutson dug for the corner at the temporary corner. John Tupa from Hutchinson with a backhoe. Down  $1\frac{1}{2}$  feet below the road surface they found a 1 inch diameter iron pin. Below the iron pin they found a rotted wood stake. They took reference ties.

May 31, 1974. Knutson set a McLeod County cast iron monument and took additional ties.

April 7, 1989. We found the monument in good condition and the reference ties good.

We accept the iron pin found by Knutson as having perpetuated the correct location of the section corner.

NORTH QUARTER corner, Section 14, Township 117 North, Range 29 West

# Certificate of Location of Government Corner

## SKETCH OF REFERENCE TIES (NO SCALE)

SECTION 11

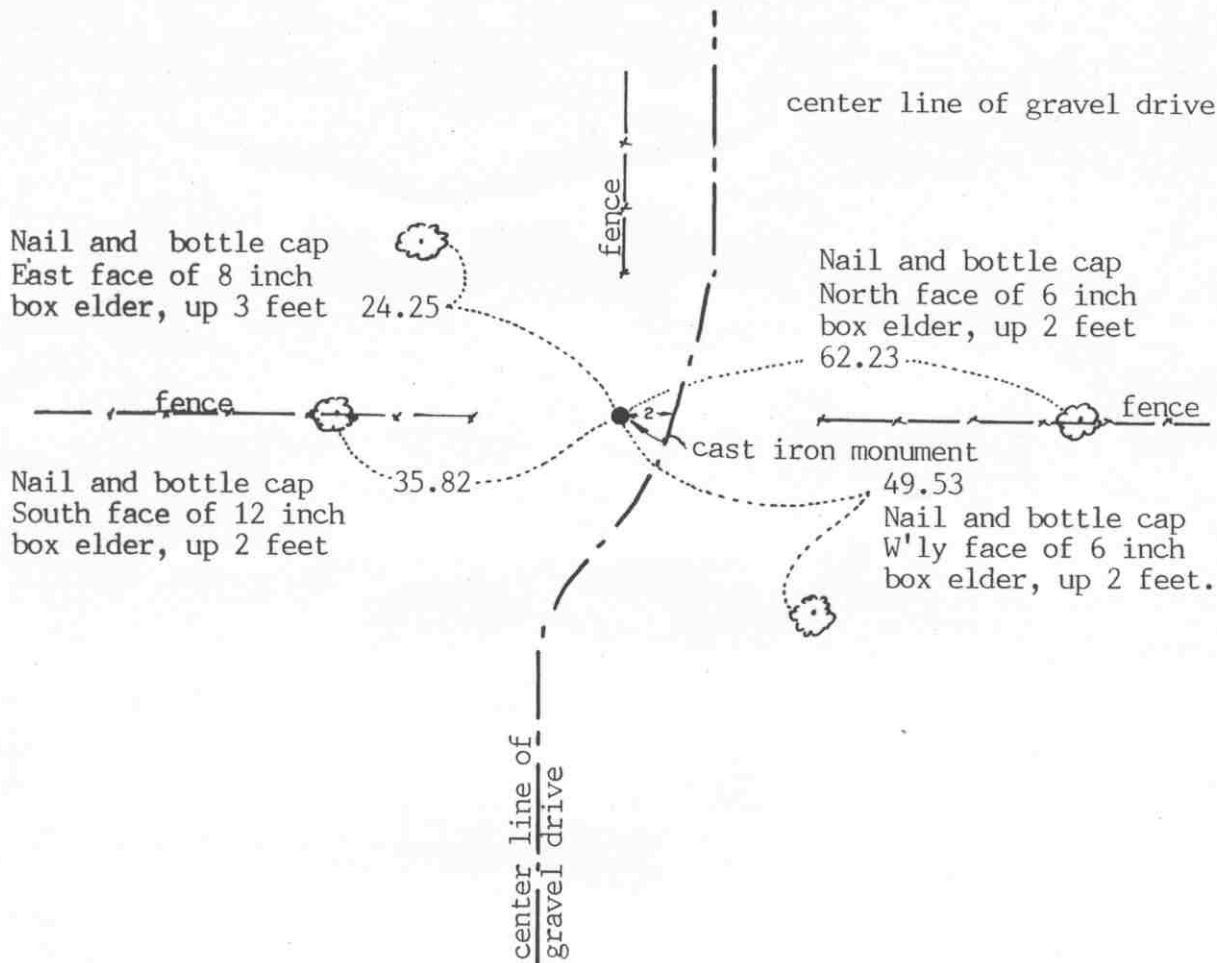

SECTION 14

Statement of evidence relative to this corner location on sheet 2

I hereby certify that this document was prepared by me or under my direct supervision.

Willard Pellinen

Willard Pellinen  
McLeod County Surveyor  
License No. 9626

Date April 18, 1991

OFFICE OF THE COUNTY RECORDER  
MCLEOD COUNTY, MINNESOTA.

I hereby certify that this document was filed in this office at 9 o'clock 4 .M. on the 22nd day of May, 1991.

Carmen Ostlie, County Recorder

By \_\_\_\_\_, Deputy

Document No. 239011

NORTH QUARTER corner, Section 14, Township 117 North, Range 29 West

## *Certificate of Location of Government Corner*

May, 1856. A.H.Runyon of the General Land Office set a post and marked 2 trees for bearing trees.

January 11, 1974. Henry Zajicek, 74 years old, has lived in the Northeast Quarter of Section 14 all his life, stated the corner is at the intersection of the extension of the fences from the north, east and west.

January 14, 1975. McCombs Knutson Associates (Dickman Knutson, county surveyor) measured the north line of Section 14 and set a temporary quarter corner at the intersection of the fences.

November 3, 1975. Mr. Zajicek again said the fence intersection should be the corner and that there should be a stone at the corner. Knutson dug and found a stone, 24 inches by 12 inches on top, down 18 inches, flat on top. Knutson set a McLeod County cast iron monument over the stone and took available ties.

May 4, 1990. We found the monument, top of monument broken off, but the remainder in place. All the old reference ties had been destroyed so we took new available ties.

We accept the stone found by Knutson as having perpetuated the correct location of the quarter corner.

## Certificate of Location of Government Corner

### SKETCH OF REFERENCE TIES

(NO SCALE)

SECTION 11

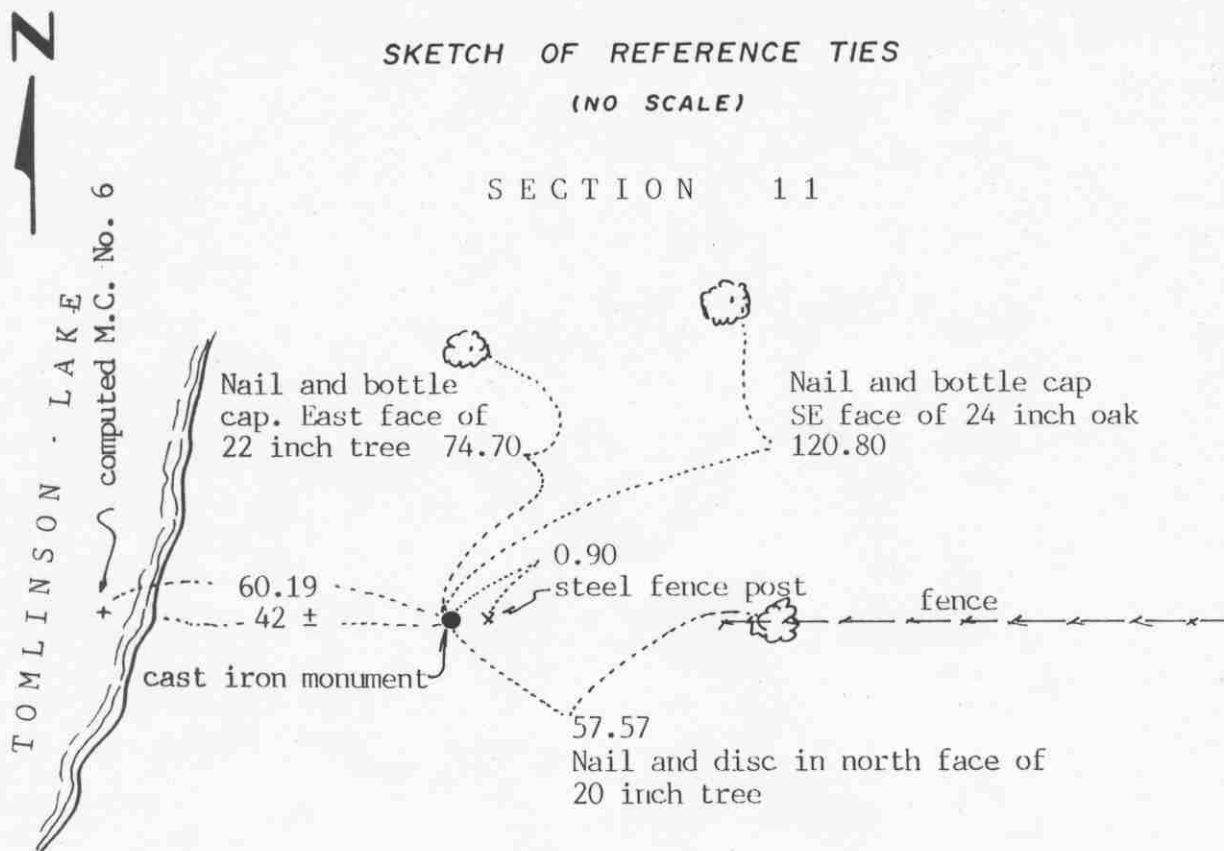

SECTION 14

Statement of evidence relative to this corner location on sheet 2

I hereby certify that this document  
was prepared by me or under my  
direct supervision.

Willard Pellinen

Willard Pellinen  
McLeod County Surveyor  
License No. 9626

Date August 24, 1991

OFFICE OF THE COUNTY RECORDER  
MCLEOD COUNTY, MINNESOTA.

I hereby certify that this document was filed in this  
office at 9 o'clock A.M. on the 27th day  
of August, 1991.

Carmen Ostlie

, County Recorder

By \_\_\_\_\_, Deputy

Document No. 240569

## *Certificate of Location of Government Corner*

1969. Lew Merrill, former county surveyor, said there was a stone along the north line of Section 14 on the east shore of Tomlinson Lake. Didn't know if it was the meander corner, but land owners had told him it was on the section line.

November 3, 1975. McCombs Knutson Associates (Dickman Knutson, county surveyor) found a stone, 18 inches by 12 inches with a sharp point up, at the westerly end of an east-west fence along the north side of Section 14. Knutson replaced the stone with a McLeod County cast iron monument and took reference ties.

This monument is 60.19 feet east of the computed location of Meander Corner No. 6 and 1821.4 feet west of the north quarter corner of Section 14. The computed location of the northwest corner of Section 14 (in the lake) is 763.88 feet west of the meander corner. Angle at the meander corner, on the south side of the line, is  $179^{\circ}43'31''$ .



East Quarter corner, Section 15, Township 117 North, Range 29 West

# Certificate of Location of Government Corner

## SKETCH OF REFERENCE TIES (NO SCALE)

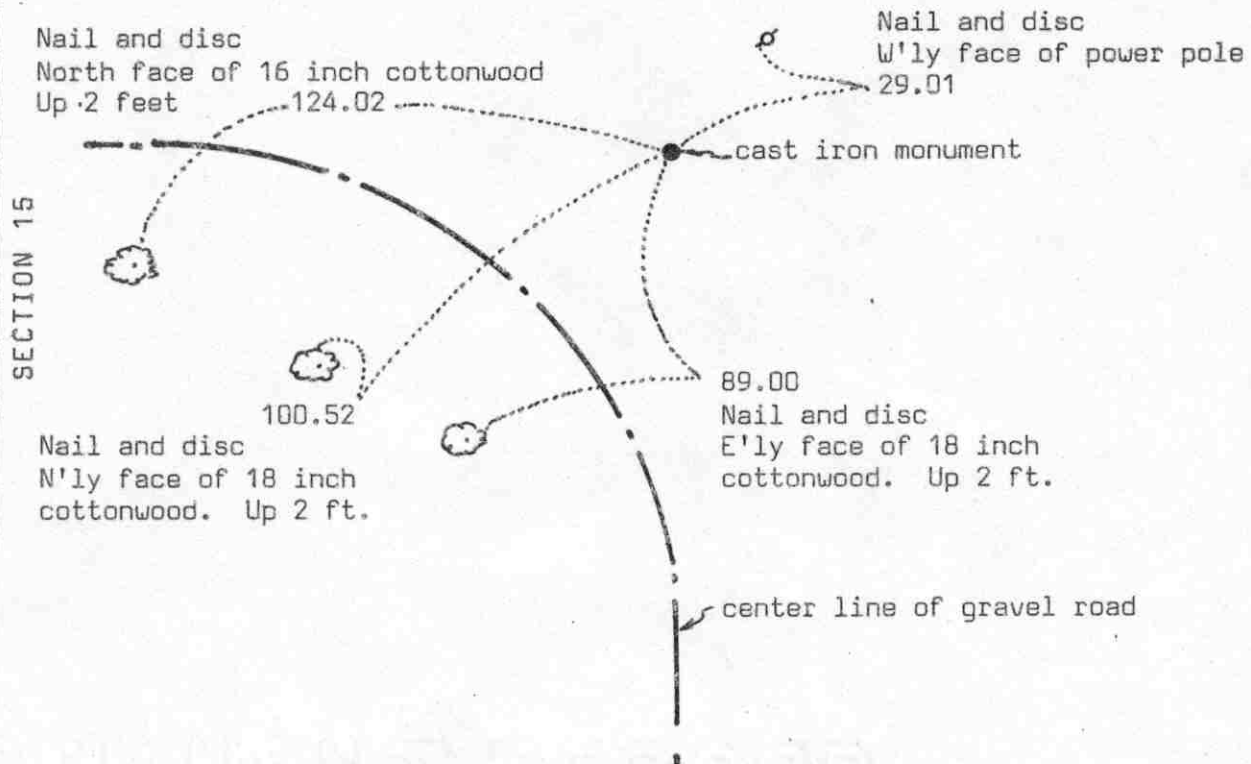

Statement of evidence relative to this corner location on sheet 2

I hereby certify that this document was prepared by me or under my direct supervision.

Willard Pellinen

Willard Pellinen  
McLeod County Surveyor  
License No. 9626

Date 6/3/90

OFFICE OF THE COUNTY RECORDER  
MCLEOD COUNTY, MINNESOTA.

I hereby certify that this document was filed in this office at 8:30 o'clock A. M. on the 18th day of June, 19 90.

Carmen Ostlie, County Recorder

By Jan Petrick, Deputy

Document No. 233930

EAST QUARTER corner, Section 15, Township 117 North, Range 29 West

## Certificate of Location of Government Corner

May, 1856. A.H.Runyon of the General Land Office established this corner. He set a post and had ties to 2 trees.

1964. J.Tofte, Jr. of the Minnesota Conservation used an old corner fence post as the quarter corner.

1967. Roy Hansen, surveyor, also used the corner fence post as the correct corner. Adjoining property owners have accepted the fence corner as marking the quarter corner.

November 15, 1974. The old fence was gone. McCombs Knutson Associates (Dickman Knutson, county surveyor) set a McLeod County cast iron monument at the location of the old fence corner, and took reference ties.

April 7, 1989. We found the cast iron monument in good condition, 2 inches below the surface of the ground, but the reference ties had been destroyed. We took new reference ties.

We accept the monument set by Knutson as marking the correct location of the quarter corner. We believe the old corner fence post had perpetuated the location of the quarter corner.

Sec. 14 and Sec 15 corner, Section \_\_\_\_\_, Township <sup>117</sup> \_\_\_\_\_ North, Range <sup>29</sup> \_\_\_\_\_ West

SECTION 14

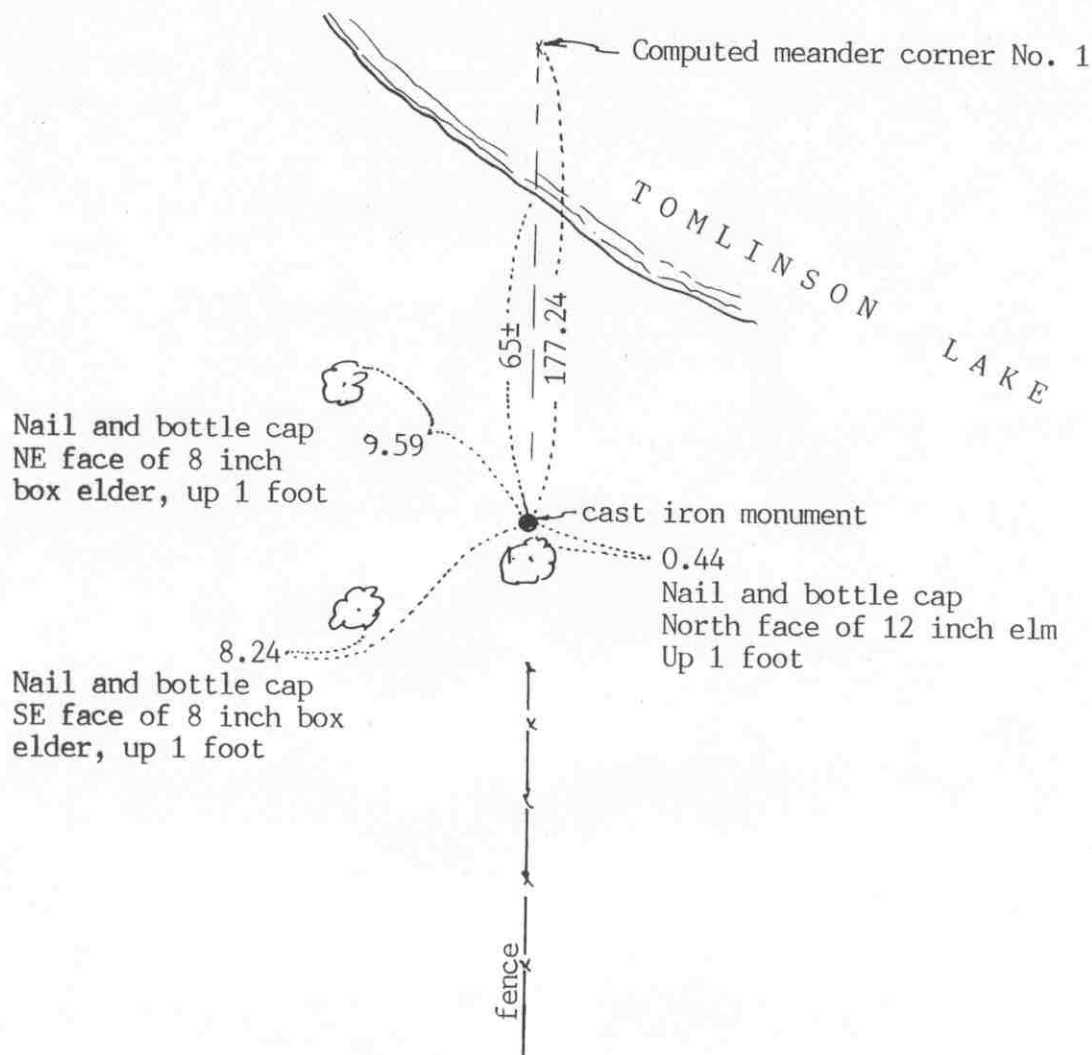

Document No. 240570

Witness corner to MC No. 1

                     corner, Section 15, Township 117 North, Range 29 West

## *Certificate of Location of Government Corner*

November 3, 1975. McCombs Knutson Associates (Dickman Knutson, county surveyor) set a McLeod County cast iron monument for a witness corner to Meander Corner No. 1 south of Tomlinson Lake between sections 14 and 15. The monument was set along an old fence which Roger Fimon, 38 years old and had lived in the Southeast Quarter of Section all his life, says has always been accepted as the section line. Other adjoining land owners have only lived here a few years.

This monument is 1422.50 feet north of the east quarter corner of Section 15 and 177.24 feet south of the computed location of the meander corner. The computed location of the meander corner is 1599.74 feet north of the east quarter corner compared with a government distance of 1617 feet and is 1012.88 feet south of the computed location of the north-east corner of Section 15 which is in the lake compared with the government distance of 1023 feet.

Computed angle at the meander corner is  $181^{\circ}12'40''$  on the east side of the line.

Point on sec. line ~~corner~~, Section 15, Township 117 North, Range 29 West

# Certificate of Location of Government Corner

## SKETCH OF REFERENCE TIES

(NO SCALE)

SECTION 10

Nail and bottle cap  
West face of 12 inch elm  
Up 3 feet

9.52

Nail and bottle cap  
South face of 7 inch elm  
Up 6 feet

12.68

cast iron monument

70

Nail and bottle cap  
West face of twin  
4 inch ash,  
up 2 feet

20.57

17.41

Nail and bottle cap  
North face of 20 inch  
cottonwood, up 7 feet

TOMLINSON  
LAKE

SECTION 15

Statement of evidence relative to this corner location on sheet 2

I hereby certify that this document  
was prepared by me or under my  
direct supervision.

Willard Pellinen

Willard Pellinen  
McLeod County Surveyor  
License No. 9626

Date April 20, 1991

OFFICE OF THE COUNTY RECORDER  
MCLEOD COUNTY, MINNESOTA.

I hereby certify that this document was filed in this  
office at 9 o'clock A.M. on the 22nd day  
of May, 19 91.

Carmin Hotvie, County Recorder

By \_\_\_\_\_, Deputy

Document No. 239013

Point on Sec. line ~~xxxxxx~~ corner, Section 15, Township 117 North, Range 29 West

## *Certificate of Location of Government Corner*

July 27, 1976. McCombs Knutson Associates (Dickman Knutson, county surveyor) set a cast iron monument along the section line between Section 10 and Section 15 on the west side of Tomlinson Lake.

May 16, 1990. We found the monument in good condition and took new reference ties.

POINT ON LINE corner, Section 15, Township 117 North, Range 29 West

# Certificate of Location of Government Corner

## SKETCH OF REFERENCE TIES

(NO SCALE)

SECTION 10

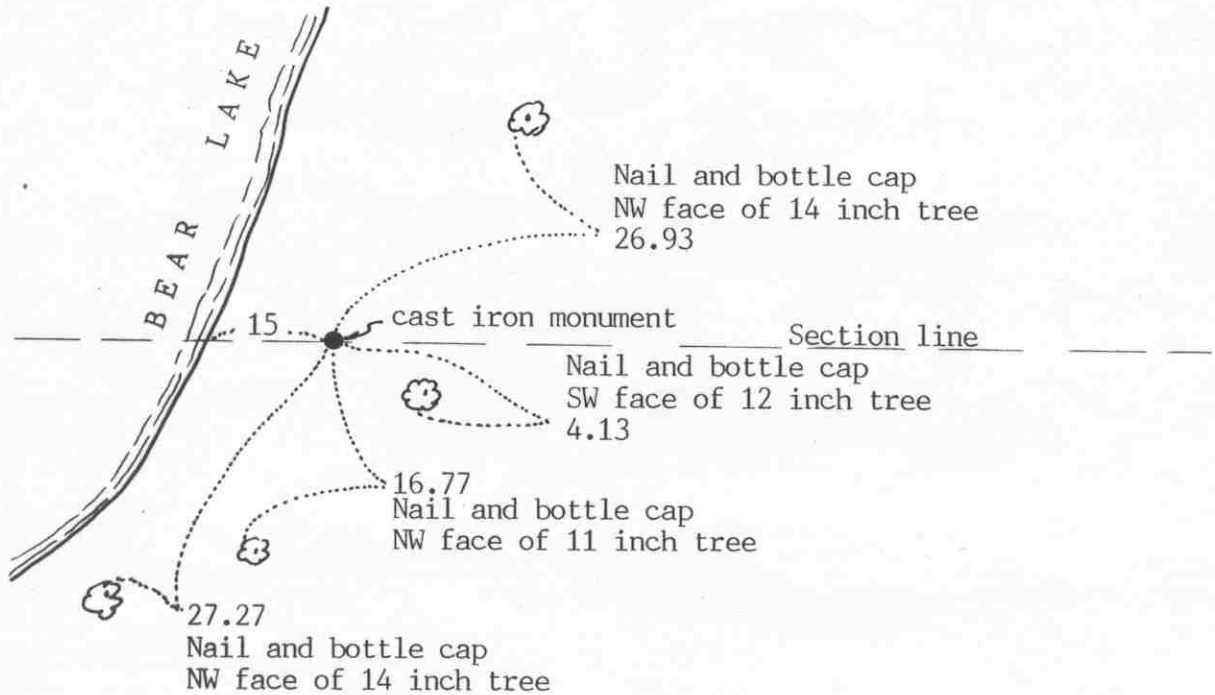

SECTION 15

Statement of evidence relative to this corner location on sheet 2

I hereby certify that this document was prepared by me or under my direct supervision.

Willard Pellinen

Willard Pellinen  
McLeod County Surveyor  
License No. 9626

Date April 17, 1991

OFFICE OF THE COUNTY RECORDER  
MCLEOD COUNTY, MINNESOTA.

I hereby certify that this document was filed in this office at 9 o'clock A.M. on the 22nd day of May, 1991.

Carmen O'Brien, County Recorder

By \_\_\_\_\_, Deputy

Document No. 239014



Point on line XXXXX corner, Section 15, Township 117 North, Range 29 West

## *Certificate of Location of Government Corner*

January 30, 1976. McCombs Knutson Associates (Dickman Knutson, county surveyor) set a McLeod County cast iron monument along the section line between Sections 10 and 15 on the east side of Bear Lake.

May 16, 1990. We found the monument in good condition and checked the reference ties.

corner, Section 15, Township 117 North, Range 29 West

# Certificate of Location of Government Corner

## SKETCH OF REFERENCE TIES (NO SCALE)

SECTION 10

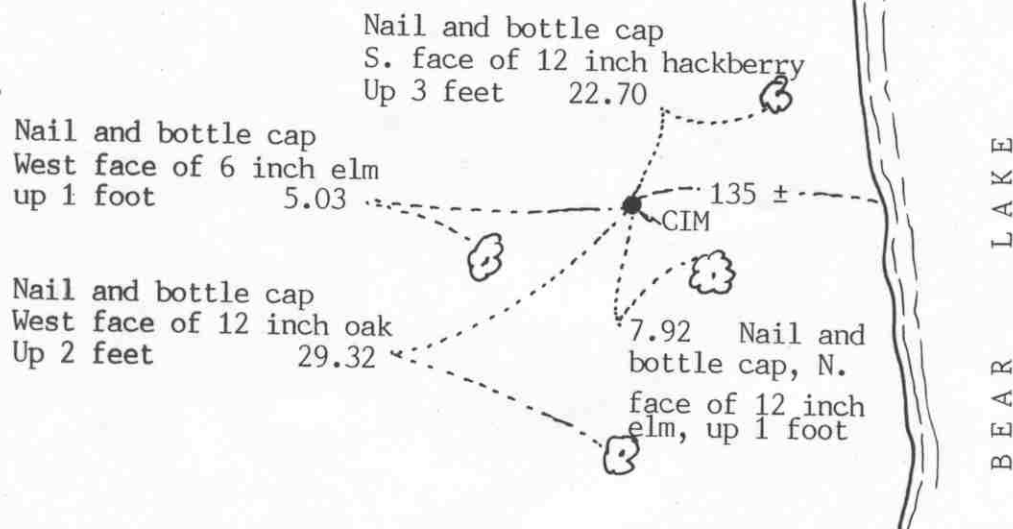

SECTION 15

Statement of evidence relative to this corner location on sheet 2

I hereby certify that this document was prepared by me or under my direct supervision.

Willard Pellinen

Willard Pellinen  
McLeod County Surveyor  
License No. 9626

Date May 15, 1991

OFFICE OF THE COUNTY RECORDER  
MCLEOD COUNTY, MINNESOTA.

I hereby certify that this document was filed in this office at 9 o'clock A. M. on the 22nd day of May, 1991.

Carmen O'Brien, County Recorder

By \_\_\_\_\_, Deputy

Document No. 239012

Point on north line of \_\_\_\_\_ corner, Section 15, Township 117 North, Range 29 West

## *Certificate of Location of Government Corner*

January 30, 1976. McCombs Knutson Associates (Dickman Knutson, county surveyor) set an iron pipe on a straight line between the section corners and took available ties.

August 26, 1976. Knutson replaced the iron pipe with a McLeod County cast iron monument.

May 17, 1990. We found the monument in good condition and took new reference ties.

EAST QUARTER corner, Section 16, Township 117 North, Range 29 West

# Certificate of Location of Government Corner

SKETCH OF REFERENCE TIES  
(NO SCALE)

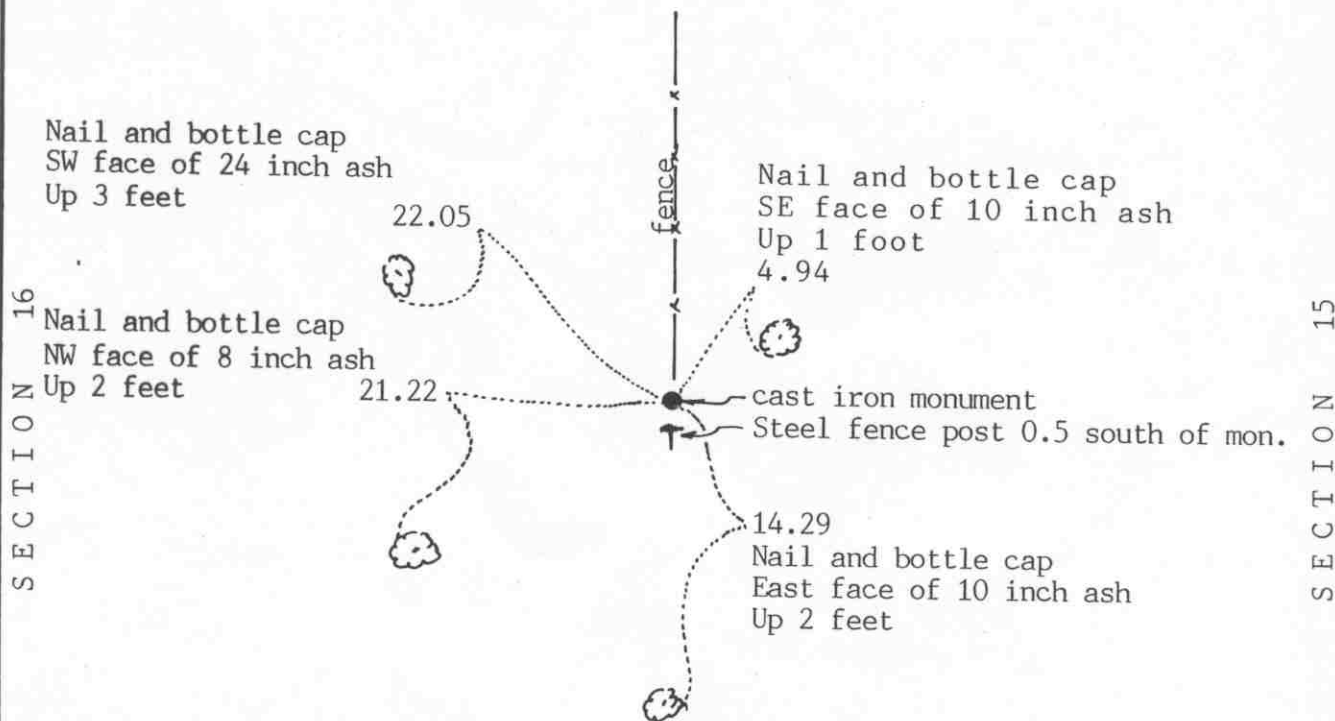

Statement of evidence relative to this corner location on sheet 2

I hereby certify that this document was prepared by me or under my direct supervision.

Willard Pellinen

Willard Pellinen  
McLeod County Surveyor  
License No. 9626

Date June 10, 1991

OFFICE OF THE COUNTY RECORDER  
MCLEOD COUNTY, MINNESOTA.

I hereby certify that this document was filed in this office at 9 o'clock A.M. on the 20th day of June, 19 91.

Carmen Ostlie, County Recorder

By Thyllis Jopkowiak, Deputy

Document No. 239535

EAST QUARTER corner, Section 16, Township 117 North, Range 29 West*Certificate of Location of Government Corner*

May, 1856. A.H.Runyon of the General Land Office set a post and marked 2 elms for bearing trees.

February 27, 1975. McCombs Knutson Associates (Dickman Knutson, county surveyor) found a 1 inch iron pipe at a fence intersection, fences north and west. Adjoining property owners agreed this is the correct quarter corner.

October 14, 1975. Knutson replaced the iron pipe with a McLeod County cast iron monument and took available ties.

May 17, 1990. We found the monument in good condition but all the reference ties had been destroyed. We took new available ties.

NORTHEAST corner, Section 16, Township 117 North, Range 29 West

# Certificate of Location of Government Corner

SKETCH OF REFERENCE TIES  
(NO SCALE)

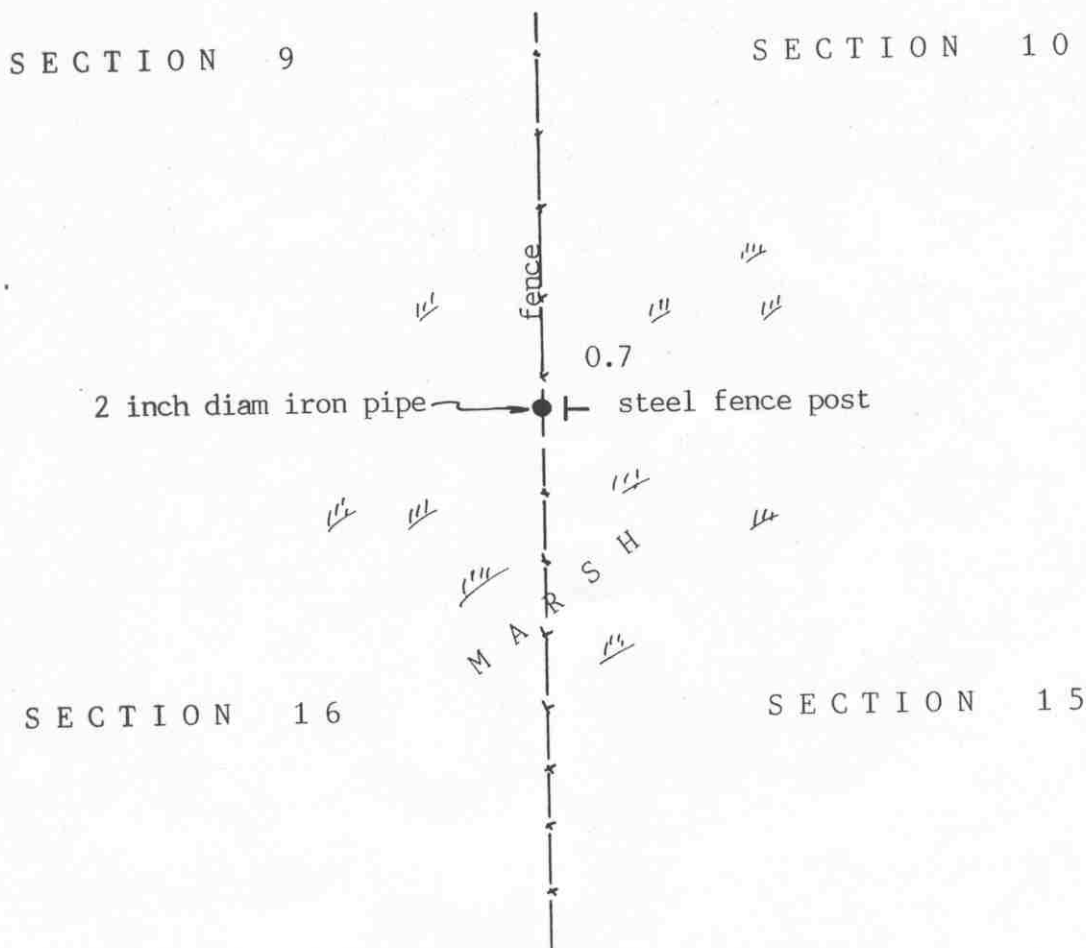

Statement of evidence relative to this corner location on sheet 2

I hereby certify that this document  
was prepared by me or under my  
direct supervision.

Willard Pellinen

Willard Pellinen  
McLeod County Surveyor  
License No. 9626

Date June 13, 1991

OFFICE OF THE COUNTY RECORDER  
MCLEOD COUNTY, MINNESOTA.

I hereby certify that this document was filed in this  
office at 9 o'clock A.M. on the 20th day  
of June, 1991.

Carmen Pathie, County Recorder

By Thyllis Jopkowsk, Deputy

Document No. 239534

NORTHEAST corner, Section 16, Township 117 North, Range 29 West**Certificate of Location of Government Corner**

May, 1856. A.H.Runyon of the General Land Office set a post, in marsh, and marked 1 oak and 1 Linden tree for bearing trees.

January 7, 1974. McCombs Knutson Associates (Dickman Knutson, county surveyor) measured the east line of Section 9 and set a temporary corner along the north-south fence line. No occupation lines running east and west.

February 27, 1975. Knutson measured the east line of Section 16.

October 14, 1975. Knutson set a 2 inch iron post along the north south fence,  $\frac{1}{3}$  of the distance from the east quarter corner of Section 16 to the northeast corner of Section 9.

May 17, 1991. We found the iron pipe along the fence and a steel fence post 0.7 east of the corner.



(NO SCALE)

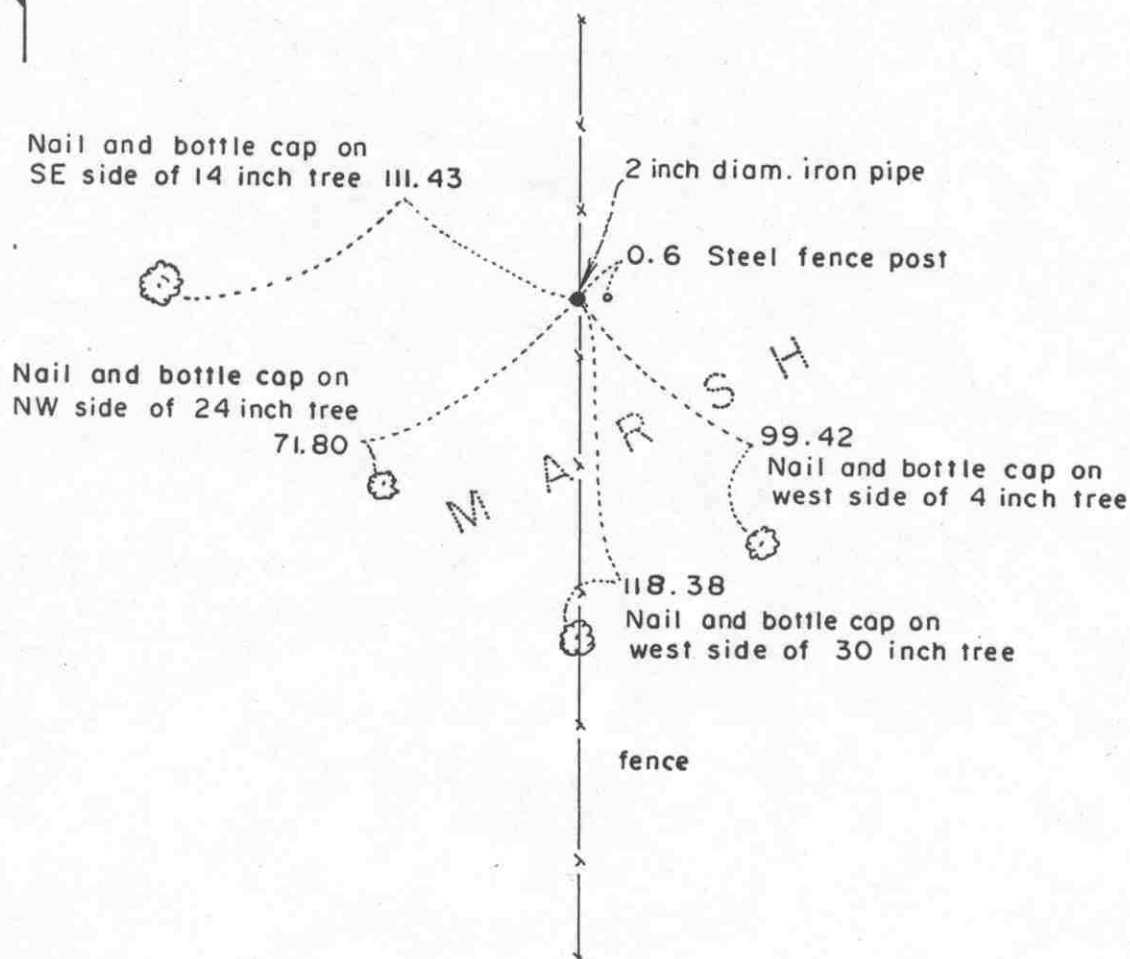

Statement of evidence relative to this corner location on sheet 2

Willard Pellinen

Date February 9, 1987

I hereby certify that this document was filed in this office at 8 o'clock A.M. on the 18th day of October, 1988.

By \_\_\_\_\_, Deputy

Document No. 225089

## *Certificate of Location of Government Corner*

This corner was established by the Government in 1856.

In October, 1975 we searched the area for the quarter corner. No occupation lines running east-west to help locate the corner, but there is a fence line running north-south which the adjoining property owners have accepted as the correct north south quarter lines of Sections 9 and 16. We searched at approximately a straight line between section corners and found an old rusted 2 inch diameter iron pipe along the fence line. This pipe was old and very rusted, broke into 2 pieces when we pulled it out. We dug around the area but didn't find anything else. We replaced the pipe with a different 2 inch diameter iron pipe and took reference ties.

1897 field notes by E.L.Higgins show a "post" at this corner but don't say what kind. We feel this is the same post as in 1897 and that it has perpetuated the true quarter corner.

East Quarter corner, Section 17, Township 117 North, Range 29 West

## Certificate of Location of Government Corner



## SKETCH OF REFERENCE TIES

(NO SCALE)

Nail and bottle cap on  
S'y side of twin 12  
inch elm 22.40

Nail and bottle cap  
south side of 12" elm  
30.75

Cast iron monument

20.30  
Nail and bottle cap  
east side of 24" elm.

Fence

Statement of evidence relative to this corner location on sheet 2

I hereby certify that this document  
was prepared by me or under my  
direct supervision.

Willard Pellinen

Willard Pellinen  
McLeod County Surveyor  
License No. 9626

Date February 9, 1987

OFFICE OF THE COUNTY RECORDER  
MCLEOD COUNTY, MINNESOTA.

I hereby certify that this document was filed in this  
office at 8 o'clock A. M. on the 18th day  
of October, 19 88.

Carmen Postlie, County Recorder

By \_\_\_\_\_, Deputy

**225091**

Document No. \_\_\_\_\_

East Quarter        corner, Section 17, Township 117 North, Range 29 West*Certificate of Location of Government Corner*

This corner was established by the Government in 1856.

In 1970, McCombs Knutson Associates Inc. found a stone and wood stake along a north-south fence line and replaced it with a McLeod County cast iron monument and took reference ties.

In 1976 they found the meander corner north of this corner (south of Echo Lake). They had a distance of 624.55 feet to the meander corner compared with a Government distance of 627 feet (9.50 chains). McCombs Knutson had a distance of 2637.58 feet to the southeast corner of Section 17 compared with a Government distance of 2640.00 (40 chains) This within  $1\frac{1}{2}$  feet of being on a proration of the Government distances between these corners.

We feel this is the true quarter corner between Sections 16 and 17 and will file a certificate at the County Records office.

Meander corner No. 24 corner, Section 17, Township 117 North, Range 29 West

# Certificate of Location of Government Corner

SKETCH OF REFERENCE TIES  
(NO SCALE)

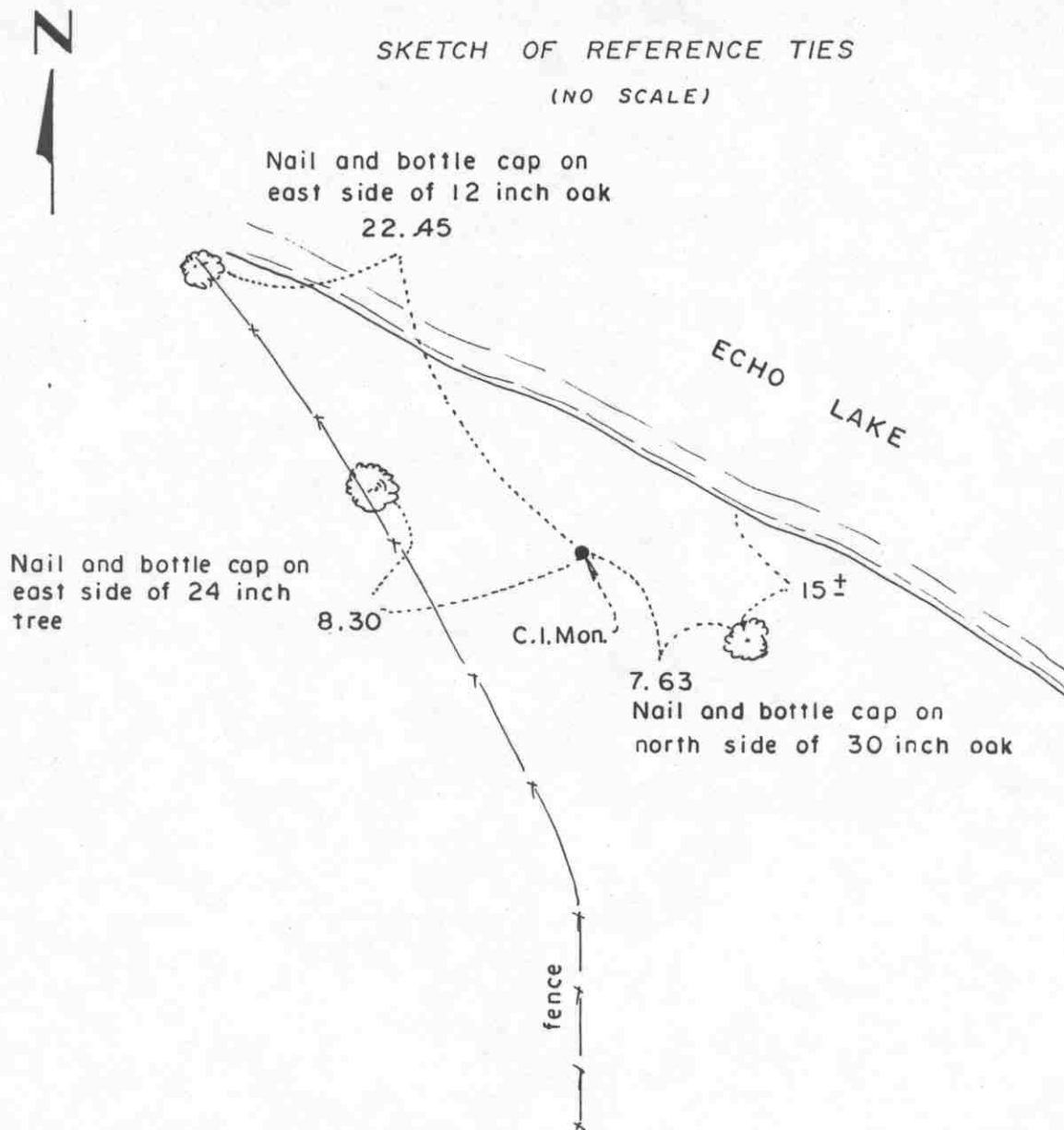

Statement of evidence relative to this corner location on sheet 2

I hereby certify that this document was prepared by me or under my direct supervision.

Willard Pellinen  
Willard Pellinen  
McLeod County Surveyor  
License No. 9626

Date February 9, 1987

OFFICE OF THE COUNTY RECORDER  
MCLEOD COUNTY, MINNESOTA.

I hereby certify that this document was filed in this office at 8 o'clock A.M. on the 18th day of October, 19 88.

Carmen Ostlie, County Recorder  
By \_\_\_\_\_, Deputy

Document No. 225090

## *Certificate of Location of Government Corner*

This meander corner between Sections 16 and 17 on the south side of Echo Lake was originally set by the Government in 1856.

In June, 1976, we searched the area for the meander corner and found a stone, about 3 inches in diameter and about 12 inches long. This stone had a sharp end which was sticking up a few inches above the surface of the ground. Below this stone we found a flat stone, about 3 inches by 12 inches. Below this flat stone we found the remains of an old wood stake. This stake was so decayed that when we tried to pick it up it fell apart. It was more like a hole in the ground than than wood. The edges of the hole seemed to have a layer of rotted wood. It was roughly 2 inches by 10 inches. We couldn't tell if the stake had been round or square.

We measured to the east quarter corner of section 17 and our distance was within a few feet of the original government distance.

We feel this was the original Government Meander corner, set a McLeod County cast iron monument, and took reference ties. No trees in the area seemed to be the government bearing trees.

MEANDER COR. NO. 23 corner, Section 17, Township 117 North, Range 29 West

# Certificate of Location of Government Corner

## SKETCH OF REFERENCE TIES (NO SCALE)

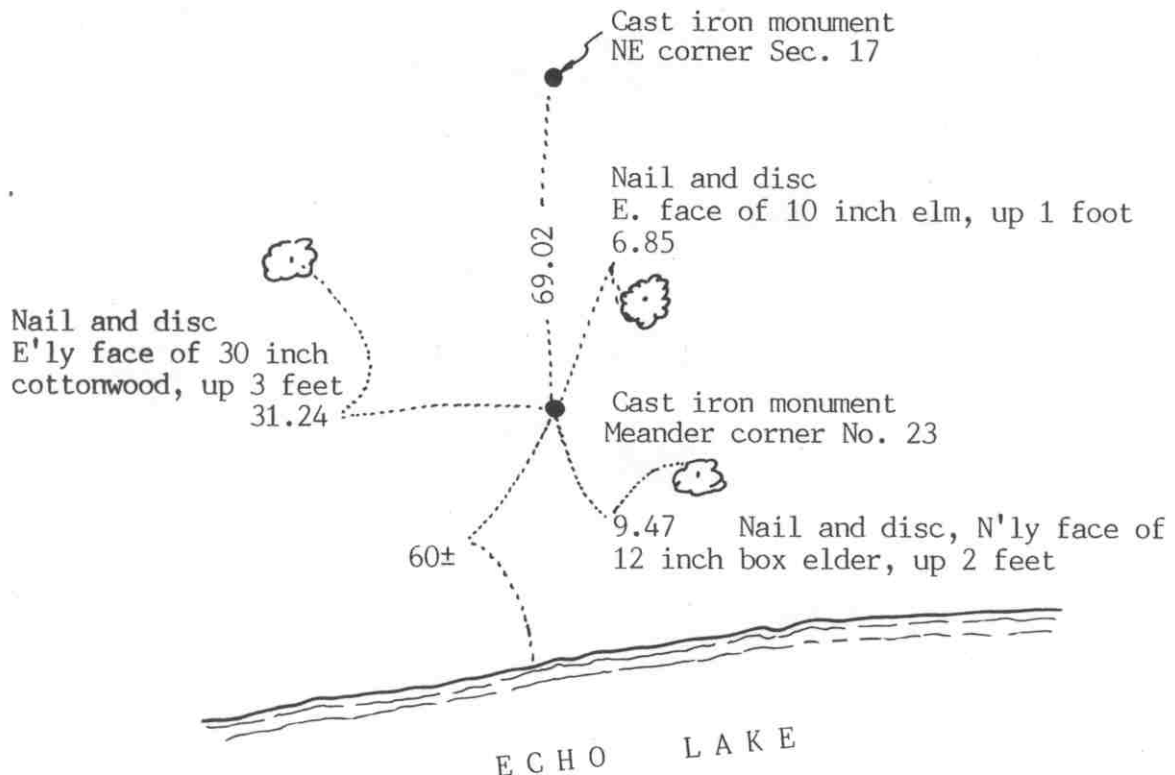

Statement of evidence relative to this corner location on sheet 2

I hereby certify that this document was prepared by me or under my direct supervision.

Willard Pellinen

Willard Pellinen  
McLeod County Surveyor  
License No. 9626

Date June 15, 1991

### OFFICE OF THE COUNTY RECORDER MCLEOD COUNTY, MINNESOTA.

I hereby certify that this document was filed in this office at 9 o'clock A. M. on the 20th day of June, 1991.

Carmen Ostlie, County Recorder

By Thyllis Jopkowsk, Deputy

Document No. 239536



MEANDER COR. NO. 23 corner, Section 17, Township 117 North, Range 29 West

## *Certificate of Location of Government Corner*

Meander corner No. 23 along the east line of Section 17, north of Echo Lake.

May, 1856. A. H. Runyon of the General Land Office set a post and marked 2 red oaks for bearing trees.

June 24, 1987. The Minneosta Department of Natural Resources set a McLeod County cast iron monument on a proration of government distances between the northeast corner of Section 17 and meander corner No. 24 which is on the east line of Section 17 south of Echo Lake. Government distance to the northeast corner was 1.04 chains and to the meander corner No. 24 the government had 29.46 chains. We measured 69.02 feet to the northeast corner and 1955.325 to Meander Corner No. 24.

May 30, 1990. We found the cast iron monument in good condition and checked the reference ties.

NORTHEAST corner, Section 17, Township 117 North, Range 29 West

# Certificate of Location of Government Corner

SKETCH OF REFERENCE TIES  
(NO SCALE)

SECTION 8

SECTION 9

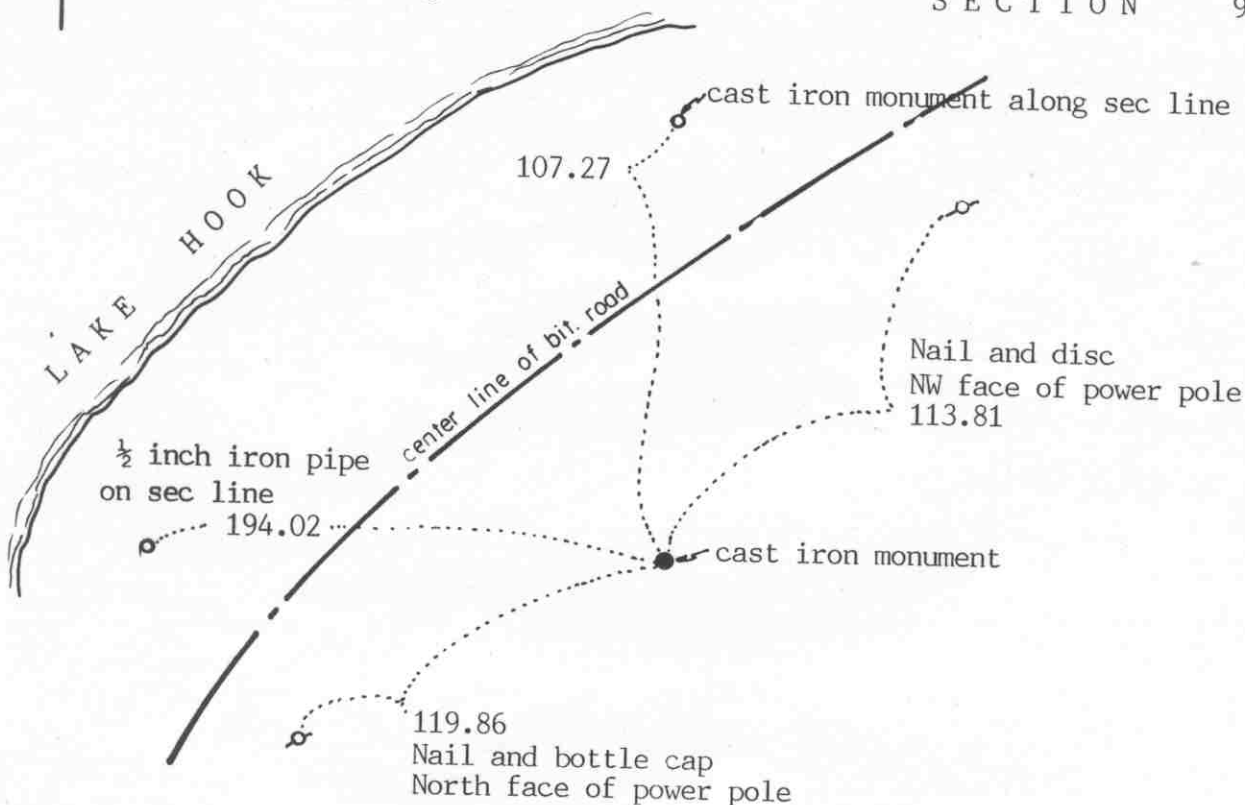

SECTION 17

SECTION 16

Statement of evidence relative to this corner location on sheet 2

I hereby certify that this document was prepared by me or under my direct supervision.

Willard Pellinen

Willard Pellinen  
McLeod County Surveyor  
License No. 9626

Date April 18, 1991

OFFICE OF THE COUNTY RECORDER  
MCLEOD COUNTY, MINNESOTA.

I hereby certify that this document was filed in this office at 9 o'clock A.M. on the 22nd day of May, 19 91.

Carmen O'Brien, County Recorder

By \_\_\_\_\_, Deputy

Document No. 239015

NORTHEAST corner, Section 17, Township 117 North, Range 29 West***Certificate of Location of Government Corner***

May, 1856. A.H.Runyon of the General Land Office set a post and marked 2 linden trees, an oak and a hickory tree for bearing trees.

October 31, 1975. McCombs Knutson Associates (Dickman Knutson, county surveyor) made a search of the area but found nothing. No evidence of the corner and no occupation lines to help position the corner. They set a cast iron monument using double proportionate measure between the west quarter corner of section 9 and the west quarter corner of section 16 and between the south quarter corner of section 9 and the southwest corner of section 8.

May 4, 1990. We found the monument in good condition and took new reference ties.

EAST QUARTER corner, Section 18, Township 117 North, Range 29 West

## Certificate of Location of Government Corner

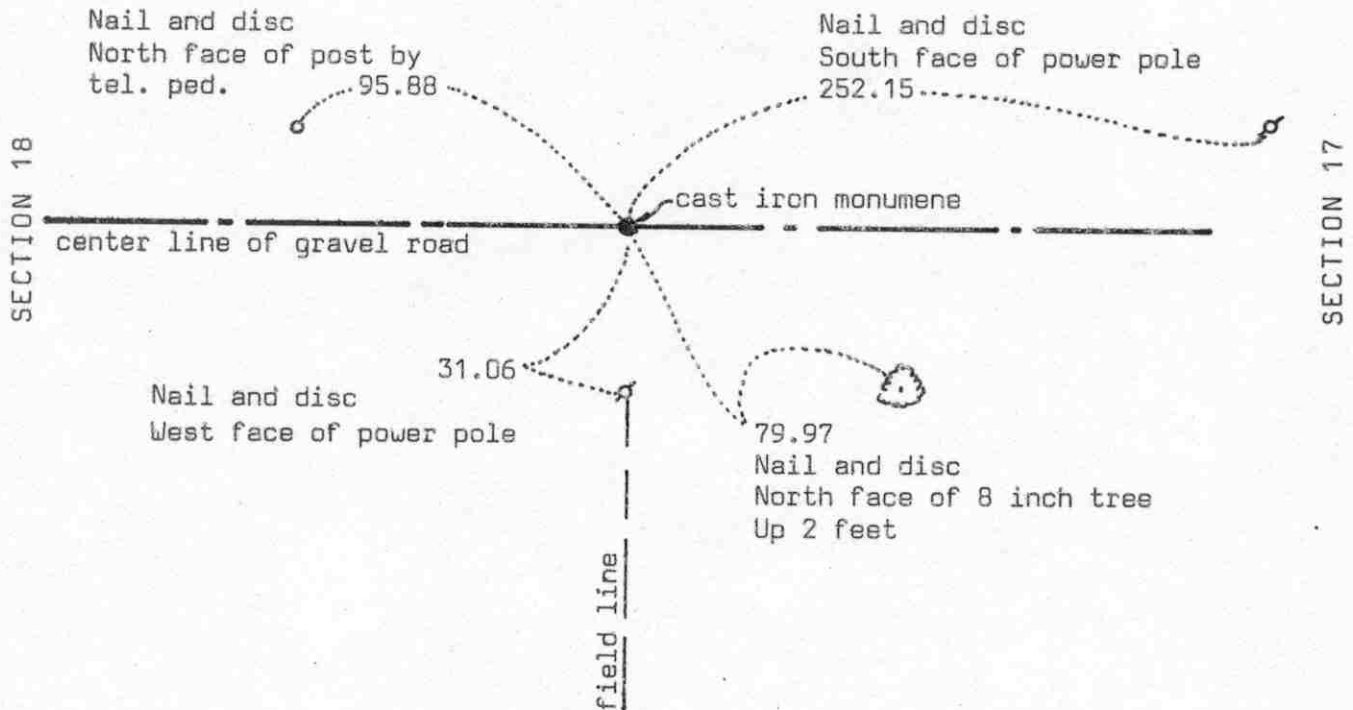
SKETCH OF REFERENCE TIES  
(NO SCALE)

Statement of evidence relative to this corner location on sheet 2

I hereby certify that this document  
was prepared by me or under my  
direct supervision.

Willard Pellinen

Willard Pellinen  
McLeod County Surveyor  
License No. 9626

Date 6/3/90

OFFICE OF THE COUNTY RECORDER  
MCLEOD COUNTY, MINNESOTA.

I hereby certify that this document was filed in this  
office at 8:30 o'clock A.M. on the 18th day  
of June, 19 90.

Carmen Oethier, County Recorder

By Paul Letrick, Deputy

Document No. 233931

EAST QUARTER corner, Section 18, Township 117 North, Range 29 West

## *Certificate of Location of Government Corner*

May, 1856. A.H.Runyon of the General Land Office established this corner. He set a post and had reference ties to a 5 inch bur oak and a 10 inch aspen.

1969. Minnesota Highway Department found a  $1\frac{1}{2}$  inch by  $2\frac{1}{2}$  inch iron monument down 28 inches below the road surface on the center line of the gravel road in line with an old fence to the south. They place a  $\frac{3}{4}$  inch by 24 inch iron pin above the monument and tied off.

August, 1969. McCombs Knutson Associates (Dickman Knutson, county surveyor) found the iron pin and the monument below the iron pin. They replaced the iron pin with a Mcleod County cast iron monument and took reference ties.

April 7, 1989. We found the cast iron monument in good condition down 4 inches below the gravel surface. Only 1 reference tie remained. We took additional ties.

We accept the iron monument found by Knutson as having perpetuated the correct location of the quarter corner.

NORTHEAST corner, Section 18, Township 117 North, Range 29 West

# Certificate of Location of Government Corner

## SKETCH OF REFERENCE TIES (NO SCALE)



SECTION 7

SECTION 8

180°55'08"

2620.09 to E½ cor.  
Section 7

88°46'13"

1½ inch diam. iron pipe

90°18'39"

2642.51 to E½ cor.  
Section 18

SECTION 18

SECTION 17

Statement of evidence relative to this corner location on sheet 2

I hereby certify that this document was prepared by me or under my direct supervision.

Willard Pellinen

Willard Pellinen  
McLeod County Surveyor  
License No. 9626

Date March 27, 1991

OFFICE OF THE COUNTY RECORDER  
MCLEOD COUNTY, MINNESOTA.

I hereby certify that this document was filed in this office at 2 o'clock P.M. on the 1st day of April 1991.

Carmen Otlic, County Recorder

By \_\_\_\_\_, Deputy

Document No. 238159

NORTHEAST corner, Section 18, Township 117 North, Range 29 West**Certificate of Location of Government Corner**

May, 1856. A.H.Runyon of the General Land Office set a post at the corner and Marked 2 aspens and an elm for bearing trees.

November, 1924. Carlisle Madson, Sr., county surveyor found an old oak stake at the corner. He measured 2620 feet to the east quarter corner of Section 7.

August 1969. McCombs Knutson Associates (Dickman Knutson, county surveyor) found an old wood stake along the east-west fence line and replaced it with a  $1\frac{1}{2}$  inch diameter iron pipe.

November 7, 1974. Knutson took reference ties to the corner.

January 31, 1984. We found the iron pipe and checked the reference ties.

May 4, 1990. We found the iron pipe but all the reference ties had been destroyed. We measured to the east quarter corner of Section 8 and had a distance of 2620.09 feet compared with 2620 feet by Madson in 1924.

We believe the wood stake found by Knutson was the same stake found by Madson in 1924 and that it has perpetuated the correct location of the section corner.

NORTH QUARTER corner, Section 18, Township 117 North, Range 29 West

## Certificate of Location of Government Corner

## SKETCH OF REFERENCE TIES

(NO SCALE)

SECTION 7

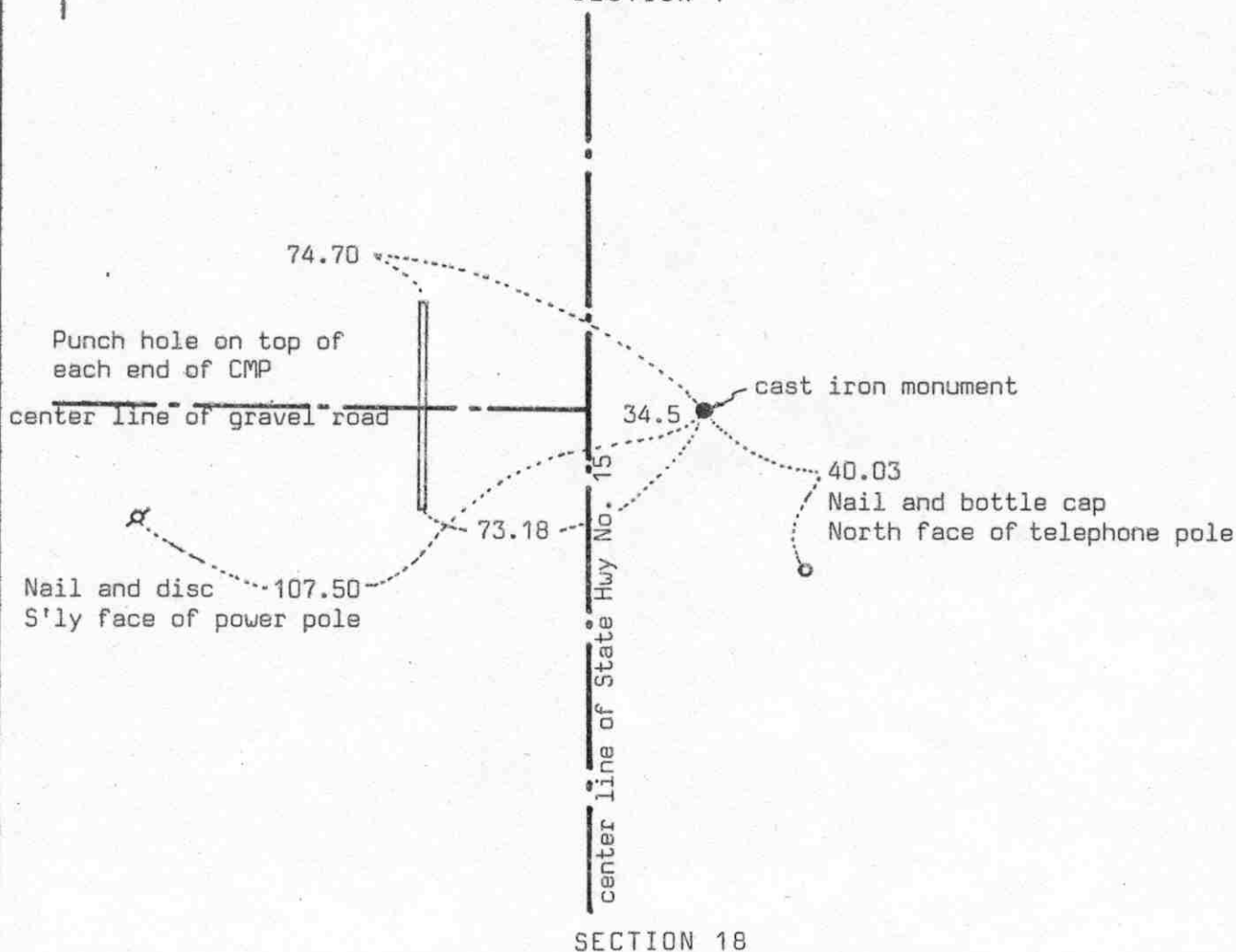

Statement of evidence relative to this corner location on sheet 2

I hereby certify that this document was prepared by me or under my direct supervision.

Willard Pellinen  
Willard Pellinen  
McLeod County Surveyor  
License No. 9626

Date June 18, 1990

OFFICE OF THE COUNTY RECORDER  
MCLEOD COUNTY, MINNESOTA.

I hereby certify that this document was filed in this office at 9 o'clock A.M. on the 9th day of July, 1990.

Carmen Ostlie, County Recorder

By \_\_\_\_\_, Deputy

Document No. 234307



NORTH QUARTER corner, Section 18, Township 117 North, Range 29 West

## *Certificate of Location of Government Corner*

May, 1856. A.H.Runyon of the General Land Office established this corner. He set a post and had ties to 2 trees.

1967. McCombs Knutson Associates (Dickman Knutson, county surveyor) found an iron at the center line of State Highway No. 15 and set the quarter corner 34.5 feet east of the found iron. Highway right of way map shows the quarter corner to be 34.5 feet of the center line.

November 1974. Knutson took new reference ties to the monument at the corner.

April 7, 1989. We found the monument in good condition and the reference ties good.

There being no evidence to the contrary, we accept the monument set by Knutson as marking the correct location of the quarter corner.

NORTHEAST corner, Section 13, Township 117 North, Range 30 West

## Certificate of Location of Government Corner



## SKETCH OF REFERENCE TIES

(NO SCALE)

SECTION 12, 117, 30

SECTION 7, 117, 29

Nail and bottle cap

South face of 20 inch cottonwood

Up 3 feet 75.71

chiseled + on top west end of conc. culvert  
39.72

cast iron monument

center line of gravel road

22.74

Nail and bottle cap

East face of power pole

SECTION 13, 117, 30

SECTION 18, 117, 29

Statement of evidence relative to this corner location on sheet 2

I hereby certify that this document  
was prepared by me or under my  
direct supervision.

Willard Pellinen

Willard Pellinen  
McLeod County Surveyor  
License No. 9626

Date 4/7/90

OFFICE OF THE COUNTY RECORDER  
MCLEOD COUNTY, MINNESOTA.

I hereby certify that this document was filed in this  
office at 4 o'clock P.M. on the 2nd day  
of May, 1990.

Armen Ostlie, County Recorder

By \_\_\_\_\_, Deputy

Document No. 233096

## Certificate of Location of Government Corner

August, 1855. This corner was established by John Ryan of the General Land Office. He set a post and had reference ties to 4 bearing trees.

1898. E.L.Higgins found a stone at the corner. He had a distance of 2624 feet to the east quarter corner and a distance of 2397 feet to the meander corner on the west side of Campbells Lake along the north line of Section 13.

September, 1971. McCombs Knutson Associates (Dickman Knutson, county surveyor) set a temporary corner on a proration of old survey distances to a found stone at the east quarter corner of Section 13 and a found stone 1/4 mile north.

October, 1971. Knutson dug for the corner and found a stone at approximately the same location as their temporary corner. They took reference ties and set a McLeod County cast iron monument in place of the stone.

December 17, 1984. We found the cast iron monument in good condition. We measured the north and east lines of Section 13 and had a distance of 2623.49 feet to the east quarter corner and a distance of 2394.39 feet to the meander corner at the west side of Campbell's Lake.

April 3, 1989. We found no ties remaining. We dug and found the monument in good condition, down 4 inches below the road surface. We took new available reference ties.

We feel the stone found by Knutson is the same stone shown in the field notes of Higgins (1898) and that it had perpetuated the correct location of the section corner.

# Certificate of Location of Government Corner



SKETCH OF REFERENCE TIES  
(NO SCALE)

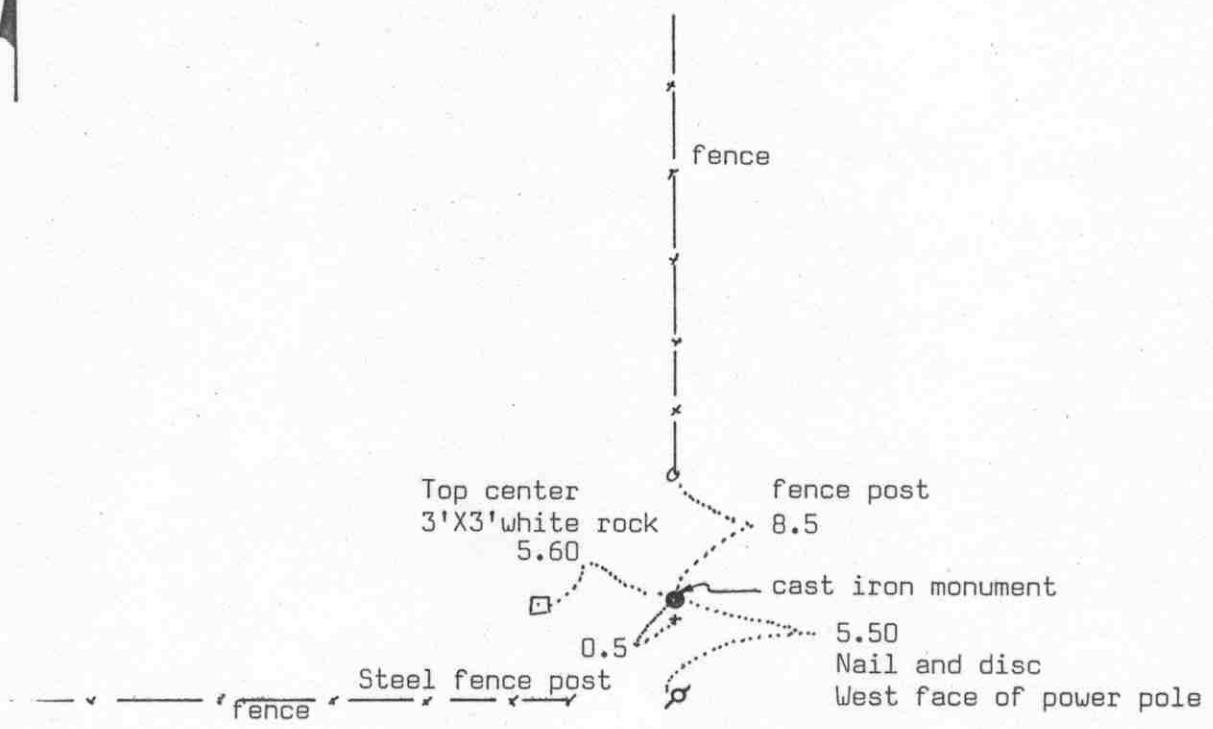

Statement of evidence relative to this corner location on sheet 2

I hereby certify that this document was prepared by me or under my direct supervision.

Willard Pellinen  
Willard Pellinen  
McLeod County Surveyor  
License No. 9626

Date 7/31/89

OFFICE OF THE COUNTY RECORDER  
MCLEOD COUNTY, MINNESOTA.

I hereby certify that this document was filed in this office at 9 o'clock A.M. on the 15th day of Aug., 19 89.

Carmen Potlie County Recorder

By \_\_\_\_\_, Deputy

Document No. 229494

EAST QUARTER corner, Section 13, Township 117 North, Range 30 West

## Certificate of Location of Government Corner

This corner was originally set by the General Land Office in 1855. John Ryan set a post and had reference ties to 2 bearing trees.

1898. E.L.Higgins found a stone at the corner. He had a distance of 2624 feet to the northeast corner of the section and a distance of 2560 to the southeast corner.

May, 1969. The Minnesota State Highway Department found a stone, quarried to an approximately 5 inch by 3 inch point.

1970. McCombs Knutson Associates (Dickman Knutson, county surveyor) found the stone with a drill hole on top. They replaced the stone with a McLeod County cast iron monument and took reference ties.

February 24, 1989. We found the cast iron monument in good condition and the reference ties good.

We believe the stone found by the highway department and later by Knutson is the same stone found by E.L.Higgins in 1898 and had perpetuated the correct location of the east quarter corner.